

# General Information

## North Wellington Health Care

### Address & Hours

North Wellington Health Care (NWHC) is a part of the Waterloo Wellington Regional Cancer Program. NWHC includes Louise Marshall Hospital.

#### Louise Marshall Hospital

630 Dublin Street  
Mount Forest, ON  
N0G 2L3

#### Hours of Operation

Open  
Monday - Friday  
8:00 a.m - 3:00 p.m

#### Contact Us

(519) 323-2210  
ext. 74301  
Fax: 519-323-4234  
  
nwhealthcare.ca

#### After Hours Care (CareChart@home)

1-877-681-3057

Please note the centre is closed on weekends and on statutory holidays.

If you need options on how to get to or from the hospital for your visits, speak to a member of your health care team.

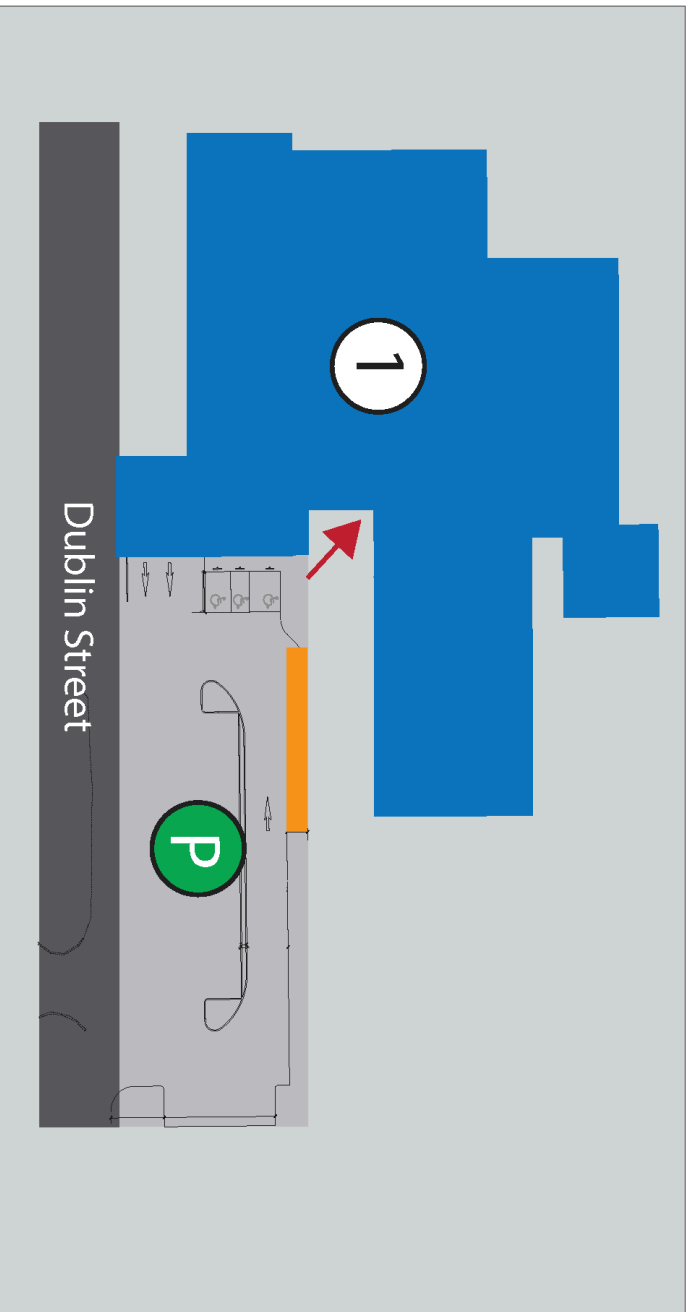

## FINDING YOUR WAY AROUND

- ① Louise Marshall Hospital
- Drop-off/Pick-up
- Ⓟ Visitor/Patient Parking
- Main Entrance

## Where can I find...

LOUISE MARSHALL HOSPITAL	
<p><b>Registration</b></p> <p><b>Gift Shop</b></p> <p><b>Central Waiting</b></p> <p><b>Vending Machine</b></p>	<p><b><u>MAIN LEVEL</u></b></p> <p>Through the Main Entrance doors you will see Central Registration, the gift shop, a central waiting area with vending machines</p>
<p><b>Emergency</b></p>	<p><b><u>MAIN LEVEL</u></b></p> <p>To the <i>left</i> of the Main Entrance</p>
<p><b>Ambulatory Care</b></p> <p><b>Oncology</b></p>	<p><b><u>MAIN LEVEL</u></b></p> <p>1-247</p> <p>1-244</p>
<p><b>Day Surgery</b></p>	<p><b><u>MAIN LEVEL</u></b></p> <p>1-100</p>
<p><b>Medical Imaging</b> <i>(X-ray, Ultrasound etc.)</i></p> <p><b>Lab</b></p>	<p><b><u>MAIN LEVEL</u></b></p> <p>1-023</p> <p>1-038</p>
<p><b>Inpatient Wing</b></p>	<p><b><u>MAIN LEVEL</u></b></p> <p>Located through Corridor A 1-196</p>

# MAIN LEVEL

**Legend**

	Washrooms		Gift Shop		Route to Oncology
	Stairs		Registration		
	Elevators		Cafeteria		

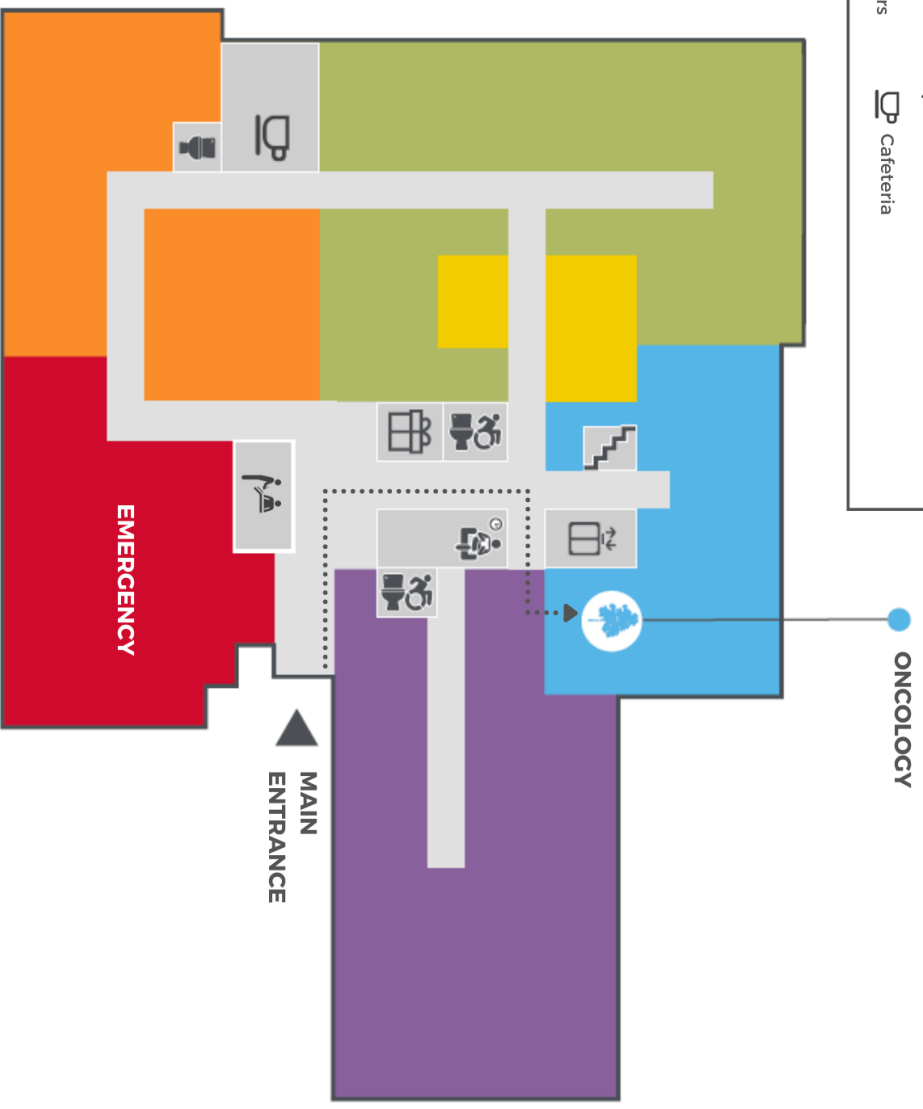

## **Parking**

Parking is FREE at Louise Marshall Hospital.

You will find a dedicated parking lot for Visitor Parking in addition to a Pick-up and Drop-off lane.

## **Tobacco & Perfume**

The Waterloo Wellington Cancer Program sites are all smoke-free. Please do not use tobacco products, e-cigarettes or vaporizers on hospital property.

Please refrain from wearing perfumes/colognes or scented products (e.g. lotions, body spray, spray deodorant) when you come to the hospital.